

GENERAL NOTES:

1. ALL DIMENSIONS AND LEVELS TO BE VERIFIED ON SITE PRIOR TO COMMENCEMENT OF THE WORKS. ANY DISCREPANCIES TO BE REPORTED TO THE ENGINEER.
2. THIS DRAWING IS TO BE READ IN CONJUNCTION WITH THE RELEVANT ARCHITECT'S AND OTHER CIVIL ENGINEERING DRAWINGS.

WATERMAIN LAYOUT LEGEND

- EXISTING WATERMAIN
- - - PROPOSED WATERMAIN 100mm ϕ (PE80)
- W PROPOSED STOPCOCK AND WATER METER BOUNDARY BOX
- FH PROPOSED FIRE HYDRANT
- S EXISTING SLUICE VALVE
- P PROPOSED SLUICE VALVE
- M PROPOSED MARKER POST & INDICATOR PLATE
- S PROPOSED SCOUR VALVE
- AV PROPOSED AIR VALVE
- TB PROPOSED THRUST BLOCK
- IRISH WATER WAYLEAVE

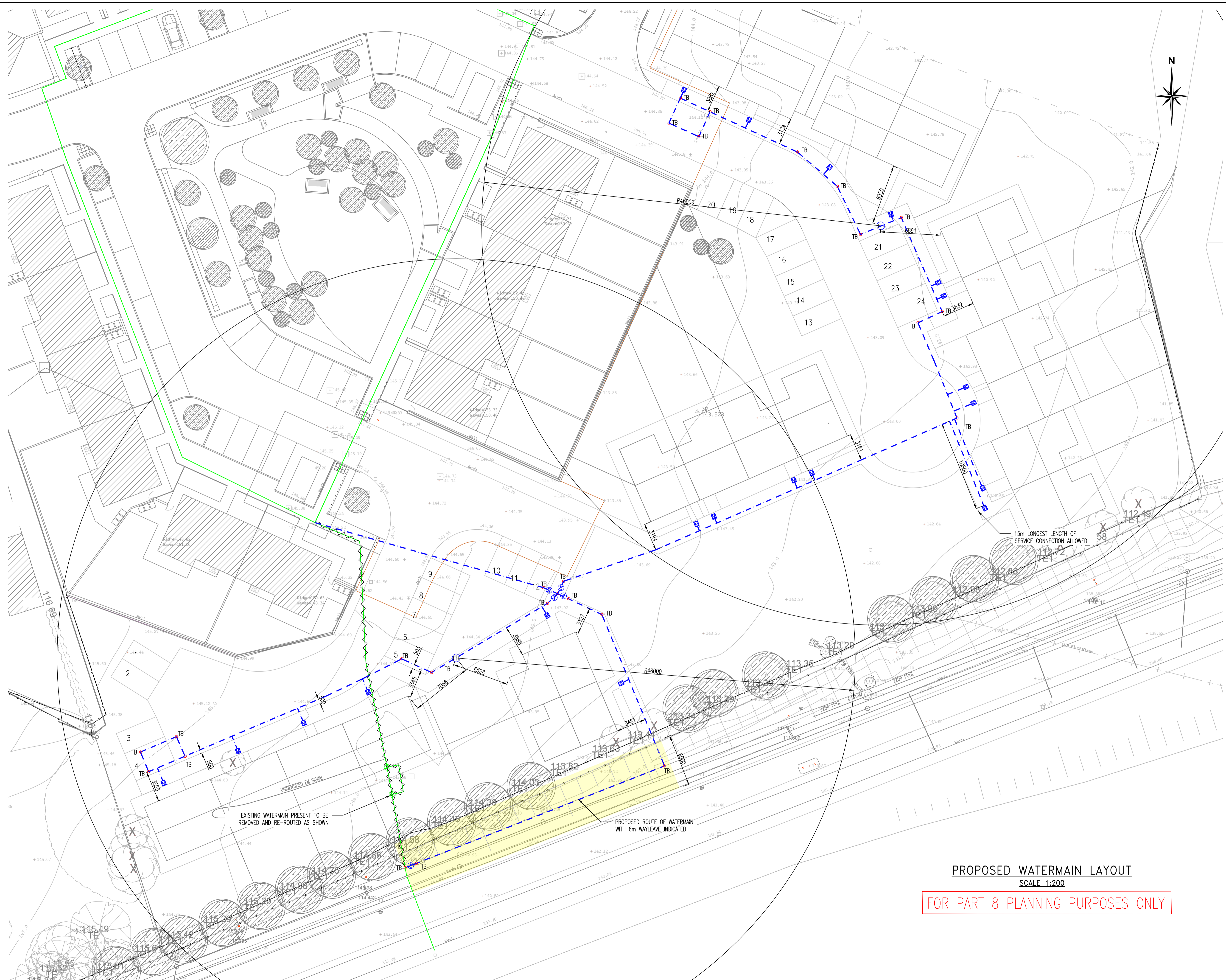

PROPOSED WATERMAIN LAYOUT
SCALE 1:200

FOR PART 8 PLANNING PURPOSES ONLY

B	26.02.18	WATER MAIN ROUTE ALTERED	PM MK
A	20.02.19	UPDATED FOR PART 8 PLANNING	PM MK
REV	DATE	DESCRIPTION	BY APPR

DRAWING STATUS:
PART_8_PLANNING

CLIENT:
WICKLOW COUNTY COUNCIL

JOB DESCRIPTION:
PROPOSED 20 UNIT HD AT AVONDALE HEIGHTS PHASE II, COUNTY WICKLOW.

DRAWING TITLE:
PROPOSED WATERMAIN LAYOUT

PROJECT No.: **P-3270** DRAWING No.: **C-04**
REV. No.: **B**

SCALE: 1:200 SHEET: A1 DATE: 18.02.19
DRAWN BY: OS CHECKED BY: MK APPROVED BY: PMCM

McMahon Associates
Consulting Civil & Structural Engineers, Project Managers
Environmental Engineers, CDM Principal Designer & Traffic Engineers
The Mill Building, Newtown Link Rd.,
Greenhills, Drogheda, Co. Louth
t: +353 (0)41 2137050
e: info@mcmahonengineers.com